

HOW TO HANDLE PROBE FOR MODEL 6036

1. HOW TO HANDLE PROBE EXTENSION ROD

① When extension rod for probe is used for measurement, pinch the edge of the probe and pull slowly.

【Notes on Handling】

- 1) If the extension rod is still secured when it is pulled, or if too much force is applied, the connection point can be damaged/broken.
- 2) The maximum weight that the extension rod can hold is 5kg; if more 5kg of weight is applied, the extension rod will no longer be covered by warranty.

※Spec of Probe extension rod

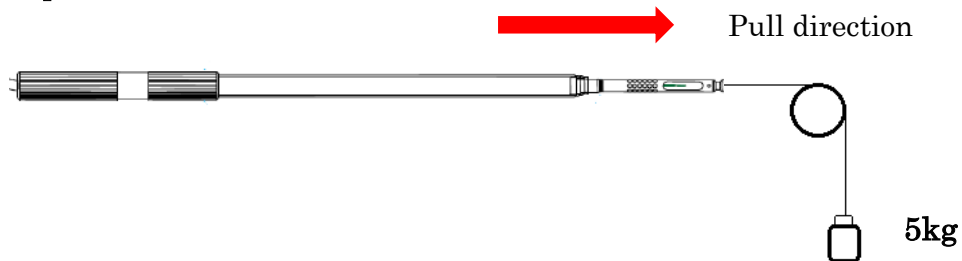

2. HOW TO HANDLE PROBE FLEXIBLE AREA (MODEL 6036)

NOTE: Please do not over-bend, or force the probe to bend beyond its limits. Flexible area should be secured within the tube (2) when not in use.

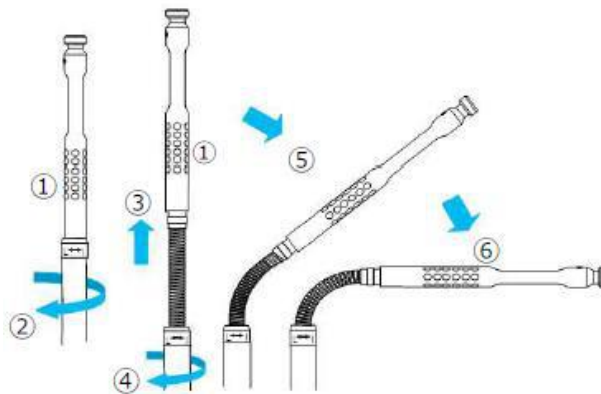

- 1) Hold area ① in place and turn piece ② in the direction shown to free the flexible extension piece.
- 2) Pull flexible area ③ and hold area ①. Turn extension rod to direction shown in ④ to lock the flexible extension out for use.
- 3) Bend slowly as shown in ⑤~⑥ picture shown above. Please bend this flexible area very slowly to avoid over-stressing the part.