



**KANOMAX**  
The Ultimate Measurements

## 0.1 MICRON PARTICLE COUNTER MODEL 3950

Amazingly lightweight particle counter with 0.1 micron sensitivity

This revolutionary 0.1-0.3 micron 2-channel particle counter comes in one of the lightest form-factors available today; clocking in at only 7.5lbs (3.4kg). It is designed for high-end contamination control environments and can be used for standalone operation or as part of an existing monitoring system to accommodate a vast array of applications. Device operation is made easy with its built-in 4.3 inch LCD color touchscreen, ability to store up to 10,000 records, and USB data transfer capability.

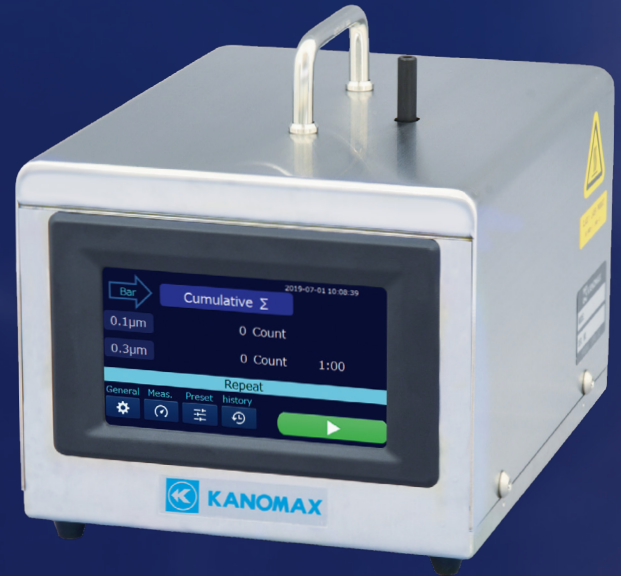

### Applications

- Up to ISO Class 1 Cleanroom Monitoring
- Semiconductor Manufacturing
- Surgical Room Monitoring

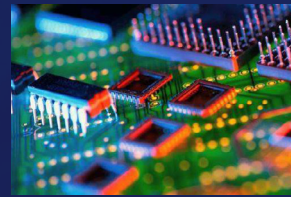

### FEATURES AND BENEFITS

- 0.1  $\mu\text{m}$  sensitivity
- 2-channels (0.1-0.3  $\mu\text{m}$ )
- 0.1CFM (2.83L/min) - Compliant with JIS B9921 and ISO21501-4
- 4.3 inch color touchscreen display
- Interface: RS-485, Ethernet, USB

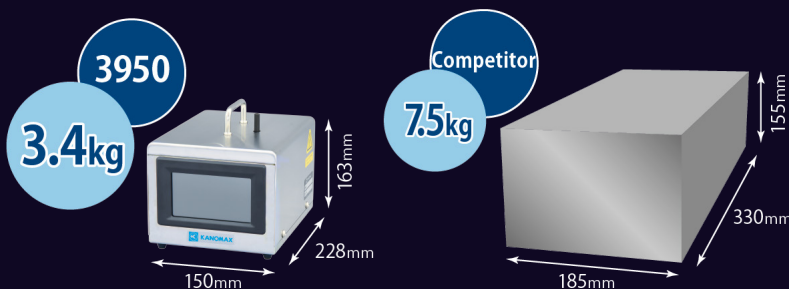

Workshop1  
Cumulative  $\Sigma$   
0.1  $\mu\text{m}$  1,989 count  
0.3  $\mu\text{m}$  495 count  
1 sec

**Monitor environments in real-time with included PC software**

# PRODUCT SPECIFICATIONS

FEATURE		VALUE
Model		Model 3950
Particle measurement	Measuring method	Light scattering
	Size distribution	2 channels (0.1 μm, 0.3μm)
	Flow rate	0.1CFM (2.83L/min); Accuracy: ±5% (compliant with JIS B9921 and ISO21501-4)
	Sampling time	From 6 seconds to 99 minutes and 59 seconds for 1 measurement cycle
	Interval time	From 6 seconds to 99 minutes 59 seconds (interval between the start and the next start of the repeat measurements)
	Sampling time	From 1 to 999 cycles or continuous measurements
	Location classification	99 locations
	Measuring mode	Repeat, Single, Continuous, Calculation
	Measurement display time	From 1 to 10 seconds
	Measurement display types	Cumulative $\Sigma$ , Differential $\Delta$ and Bar graph
	Maximum measurable concentration	10,000,000 particles/m <sup>3</sup> at 10% coincidence loss (compliant with JIS B9921 and ISO21501-4)
	Counting efficiency	50±20% (for 0.1μm PSL particle) ; 100±10% (for 0.2μm PSL particles) (compliant with JIS B9921 and ISO21501-4)
	False count	≤1 particle/35 minutes
	Size resolution	≤15% for PSL particles near 0.3μm (compliant with JIS B9921 and ISO21501-4)
Vacuum	Internal pump	
Display		4.3 inch color LCD, resistive touch panel
Communication	Standard	USB (Host: for printer and USB flash memory, Device: for PC) Ethernet, MODBUS (RS485)
Recording media	Datalogging	Up to 10,000 records
	Data format	CSV format
Language		English, Japanese
Power	External supply	AC adaptor Input 100 to 240 V
Operating environment	Main body	From 15 to 35 °C, from 0 to 85%RH (with no condensation)
Dimensions		W150 X H163 X D228 mm
Weight		3.4kg

Dimensions Diagram

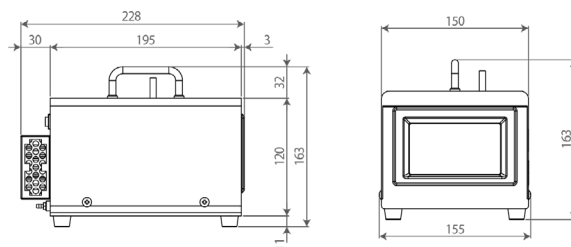

**KANOMAX USA, INC.**  
 219 US HWY 206,  
 ANDOVER, NJ 07821 USA  
 TEL: 973-786-6386  
 FAX: 973-786-7586  
 E-MAIL: SALES@KANOMAX-USA.COM  
 URL: WWW.KANOMAX-USA.COM

**DISTRIBUTED BY:**

